

## FLEXCITE SERIES

Dual Bend 60875

## Flex Light



### Features

1. Dual bend performance to fix many plane, curved and complex irregular structures at will.
2. On-site cuttable and assembly for fast and flexible customization operation, with end cap sealed by gluing process.
3. Customized length with overall appearance in the same size by die-casting process.
4. Dimmable available with PWM signal.
5. Compared with traditional fragile glass and harden/yellowing easily PVC sheathing material, silicon extrusion technology is an advanced process, with high-efficiency production capacity and environmentally-friendly characteristics. Additionally, with high grade appearance, soft bend flexibility, strong impact resistant and high weather resistance.
6. Up to 50,000h LED lifespan and 5 years warranty.
7. IP67[wet] waterproofing for indoor and outdoor usage.

### Application

Ideal for decorative and contour lighting for commercial, architectural and landscape space.

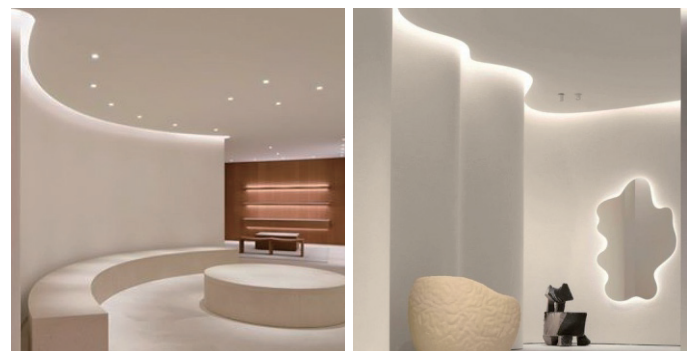

## Flex Light

### Specification

#### Dimension / Diagram

Endcap sealed by gluing process

L: Total length  
 Lb: Luminous surface length  
 N: Number like 1, 2, 3.....

La: LED strip length  
 L1: LED strip increment

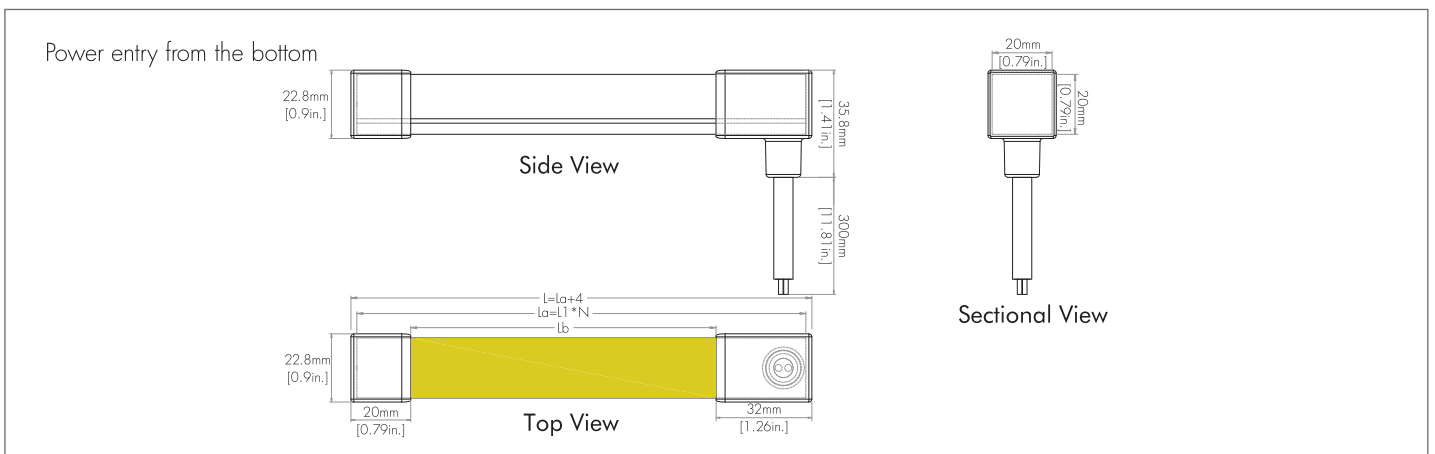
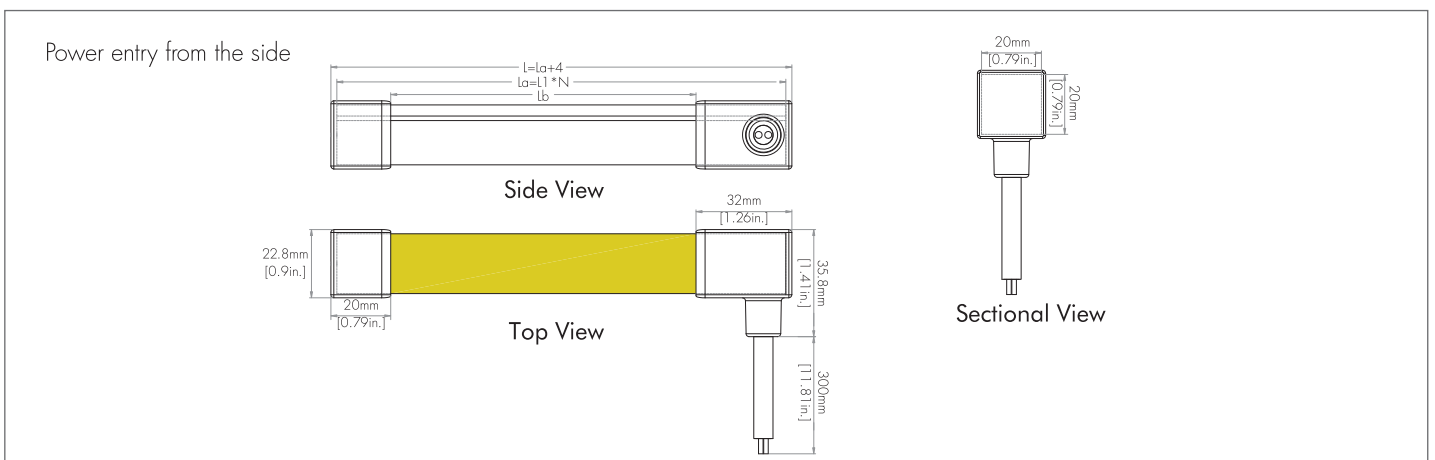
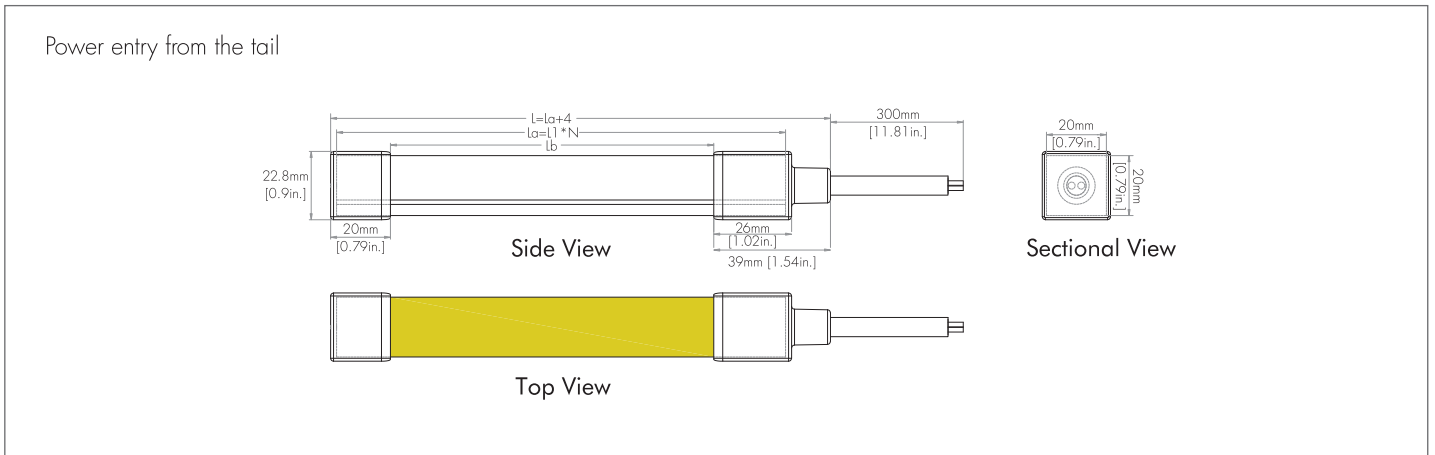

### Specification

#### Dimension / Diagram

Endcap sealed by die-casting process

L: Total length  
 Lb: Luminous surface length  
 N: Number like 1, 2, 3.....

La: LED strip length  
 L1: LED strip increment

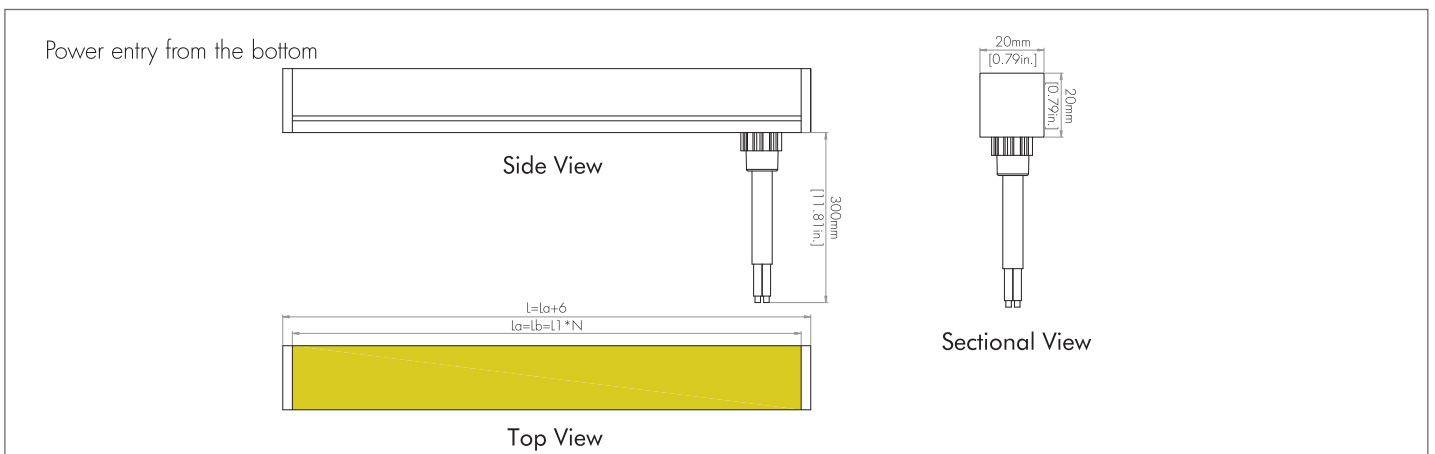
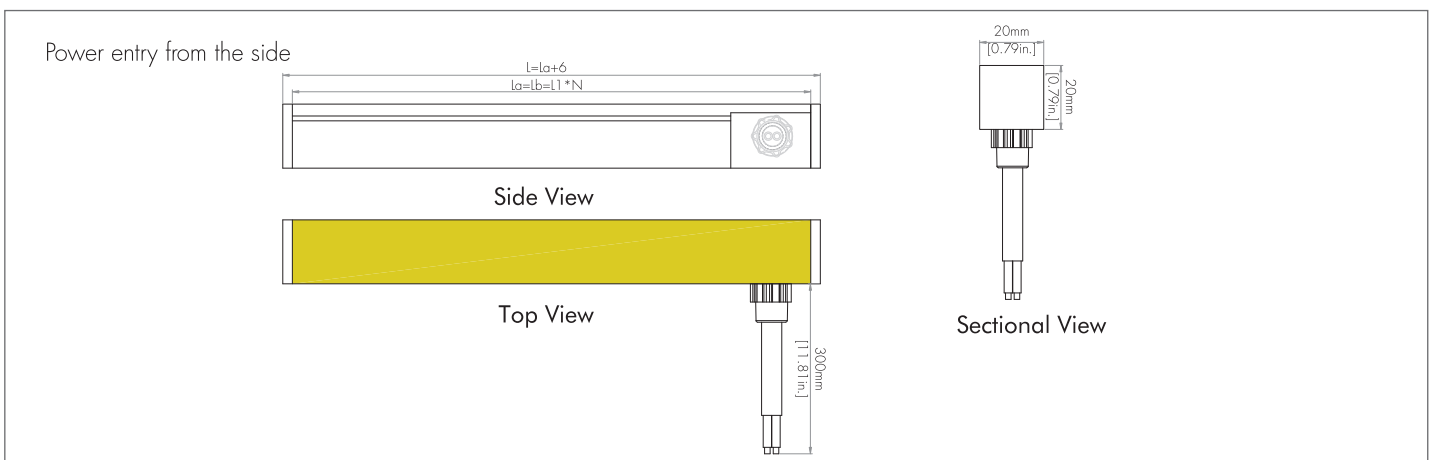
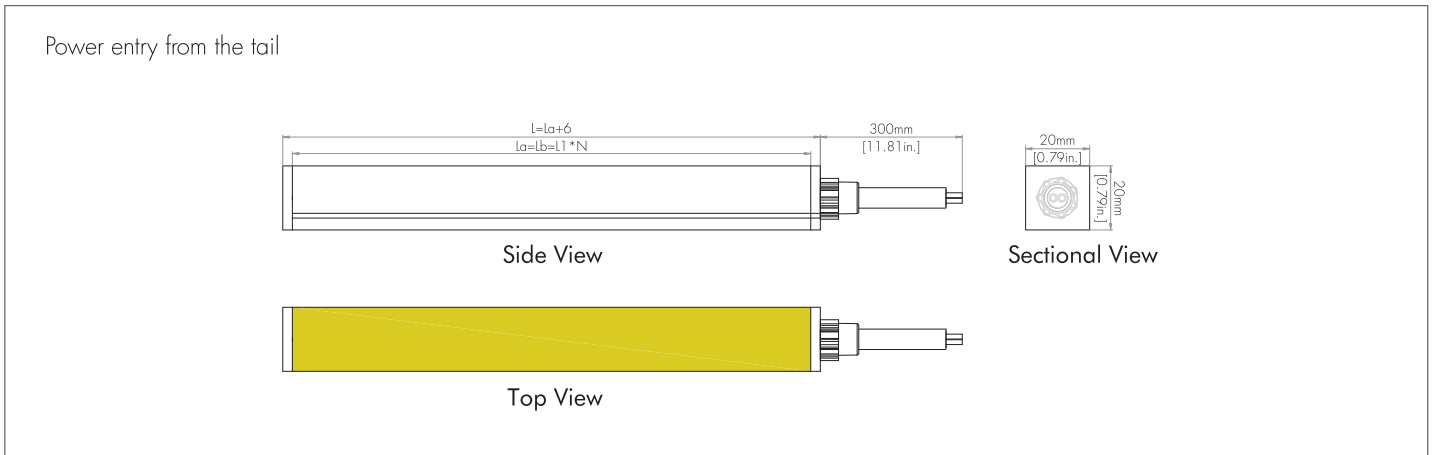

## Flex Light

### General Parameters

Part No.	Style	Dimension	Max. Run Length (La)	Strip Increment (L1)	LED Type	LED QTY	IP&IK Rating	Operating Ambient	Lifespan	Warranty
60875	Dual Bend (RGBW)	W20xH20mm	5M (Power fed on one side)	62.5mm	5050	96LED/M	IP67 & IK07	Ta: -20~45°C	50,000h (RGBW)	5 years

### Photoelectric Parameters

Part No.	Style	Power ±10%	Operating Voltage	Finished Product CCT/ Wavelength	IP67 CRI80, 4000K		IP67 CRI90, 4000K		Beam Angle
					Luminous Flux±10%	Light Efficiency	Luminous Flux±10%	Light Efficiency	
60875	Dual Bend (RGBW)	14W/M	24VDC	R:620-630nm G:518-528nm B:460-470nm W:3000K±150K Other CCT on demand	R:70lm/M G:190lm/M B:40lm/M W:220lm/M Mix:520lm/M	/	R:70lm/M G:190lm/M B:40lm/M W:180lm/M Mix:480lm/M	/	120°

#### Note:

- (1) Luminous flux for CCT 2700K is 10% lower, for CCT 3000K/3500K is 5% lower, for CCT 5000K/6000K is the same, compared with 4000K.
- (2) The power of the strip need to be reduced to 9W/M[2.74W/ft.]@White&CCT for operating ambient temperature in -20~55°C[-4~131°F].
- (3) Installation accessories pack should be ordered separately according to specific case.

### Light Distribution Diagram

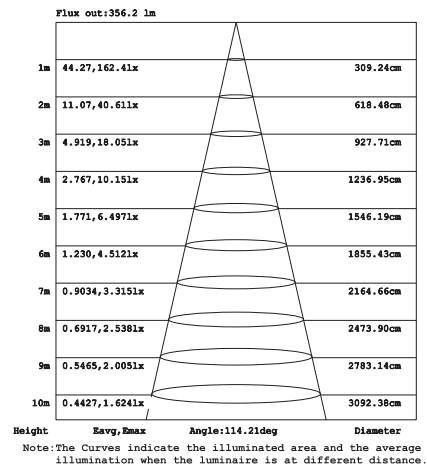
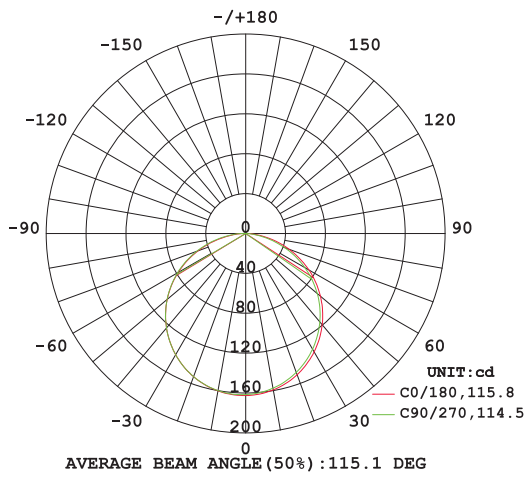

RGBW, 4000K, CRI90

### Installation

Option 1: Fixed by bracket.

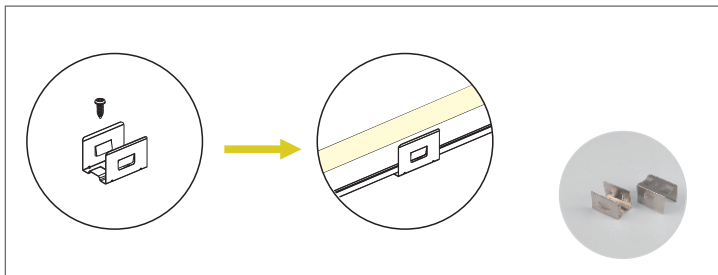

Option 2: Fixed by aluminum channel.

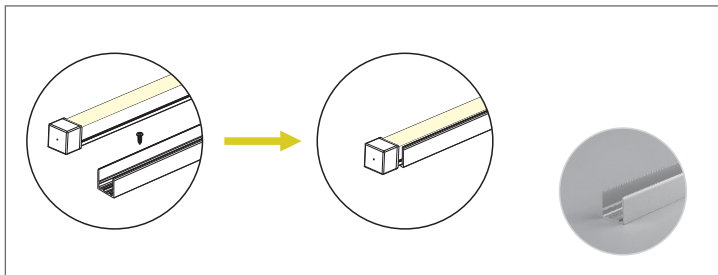

Option 3: Fixed by bendable bracket.

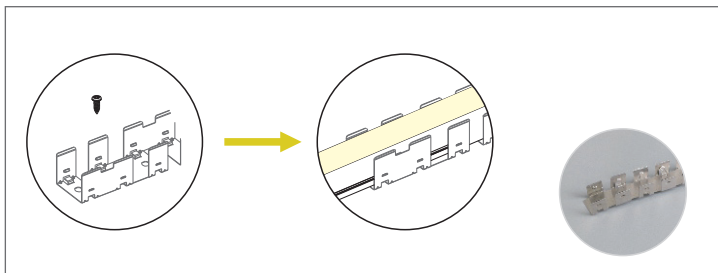

Note: It's also support surface & recessed mounting by gluing process.

The groove size is shown as below

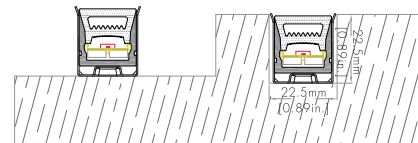

The groove size is shown as below

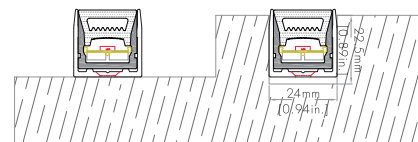

The groove size is shown as below

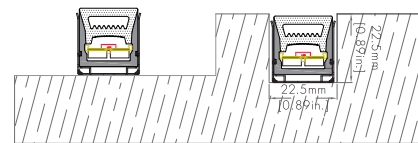

### Connection

Dimming and tuning status for RGBW

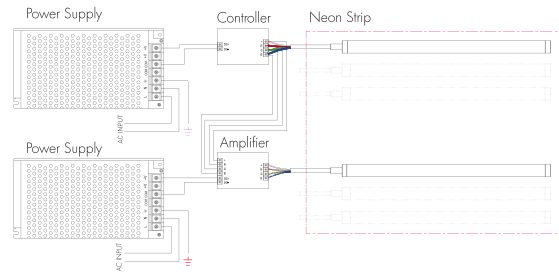

Dimming and tuning status for RGBW

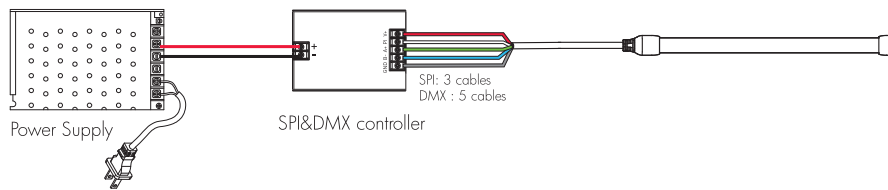

## Notice

1. Adopt suitable power supply with power is 20% higher than the max. power of product, to ensure long time performance of power supply.
2. Do not install it when power is on. Before powering on, make sure the wiring is correct.
3. Avoid privately changing or damaging the circuit or other component on the product.
4. Avoid scrape, twist and irregular bend during installation, which might cause non repairable status for the product.
5. Minimum bending diameter definition, is 200mm[7.87in.] for top-bend and 280mm[11in.] for side-bend, too small bending diameter will break the product.
6. Minimum twist angle definition, is 360° per 1000mm[39.4in.] length.
7. Product linked in over long length will lead to problem of overload or uneven brightness.
8. To protect your eyes, do not stare at the product for a long time while it's illuminated.
9. Only professional personnel can install, dismantle and repair.
10. Bend and twist diagram is shown as below.

